

inductive dual sensor for rotary actuators Ni4-DS20-2AZ31X2-B3151

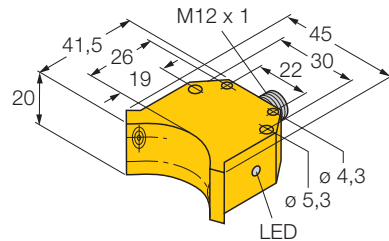

- dual sensor, housing style DS20
- plastic, PBT-GF30-VO
- two switching outputs for monitoring the position of rotary actuators
- mounting on all standard actuators without additional mounting hardware
- 4-wire AC, 20...250 VAC
- 4-wire DC, 10...300 VDC
- 2x normally open
- connector, 1/2"

Wiring diagram

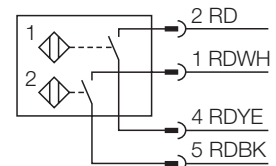

Function principles

Inductive proximity switches are designed for wear-free non-contact detection of metal objects. Dual sensors are especially designed for position detection in rotary actuators. They combine the reliability of non-contact inductive sensor system with the flexibility of a modular housing system.

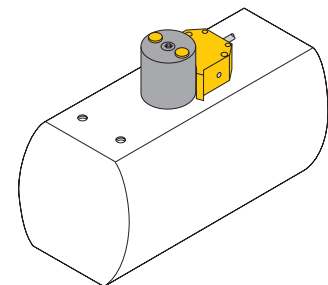

Type	Ni4-DS20-2AZ31X2-B3151
Ident-No.	1305000
Rated operating distance S_n	4 mm
Mounting mode	non-flush
Hysteresis (switching distance)	3... 15 %
Min. repeat accuracy	≤ 2 %
Temperature drift	≤ ± 10 %
Operating temperature	-25 ... + 70 °C
Rated operational voltage (AC) U_B	20... 250 VAC
Rated operational voltage (DC) U_B	10... 300 VDC
Rated operational current (AC) I_e	≤ 100 mA
Rated operational current (DC) I_e	≤ 100 mA
Line frequency	50... 60 Hz
Max. OFF-state current	≤ 1,7 mA
Max. switching frequency	≤ 0,02 kHz
Rated insulation voltage	≤ 1,5 kV
Surge Current	≤ 1 A (≤ 10 ms max. 5 Hz)
Output function	4-wire, 2x normally open
Max. voltage drop at I_e	≤ 6 V
Min. operational current I_m	≥ 3 mA
Housing style	dual sensor for valve monitoring; DS20
Dimensions	42 x 45 x 20 mm
Housing material	plastic, PBT-GF30-VO
Active face	plastic, PBT-GF30-VO
Wiring	connector, 1/2"
Vibration resistance	55 Hz (1 mm)
Shock resistance	30 x g (11 ms)
Degree of protection	IP67
Switching status indication	2 x LED yellow / red

**inductive
dual sensor for rotary actuators
Ni4-DS20-2AZ31X2-B3151**

Mounting instructions

see mounting accessories

**inductive
dual sensor for rotary actuators
Ni4-DS20-2AZ31X2-B3151**

Accessories

Typ	Ident-No.	Description	Dimension drawing
BTS-DS20-TP1	6900155	actuation kit (puck); end position dampened; hole pattern on flange surface 80 x 30 mm; connection shaft (shaft extension) height 20 mm / Ø max. 30 mm	
BTS-DS20-TK1	6900156	actuation kit (puck); end position dampened; hole pattern on flange surface 80 x 30 mm (130 x 30 mm); connection shaft (shaft extension) height 30 mm / Ø max. 30 mm	
BTS-DS20-KEY	6900136	actuation kit (puck), end position dampened and adjustable switch point; hole pattern on flange surface 80 x 30 mm (130 x 30 mm); connection shaft (shaft extension) height 20 / Ø max. 22 mm	